



New Brunswick™ I26/26R Shaker Platform Installation

Short Instruction

Copyright

Copyright © 2014 Eppendorf AG, Germany. No part of this publication may be reproduced without the prior permission of the copyright owner.

The company reserves the right to change information in this document without notice. Updates to information in this document reflect our commitment to continuing product development and improvement.

Trademarks

Eppendorf® and the Eppendorf logo are registered trademarks of Eppendorf AG, Germany.

New Brunswick™ is a trademark of Eppendorf AG, Germany.

Trademarks are not marked in all cases with ™ or ® in this manual.

Eppendorf has attempted to identify the ownership of all trademarks from public records. Any omissions or errors are unintentional.

1 Platform Installation Instructions

1.1 Introduction

Eppendorf recently changed the platform installation and removal procedure for the New Brunswick™ I26/26R Shaker. This manual is intended to provide you with step-by-step installation instructions as it may differ from what is in your I26/26R operating manual.

1.2 For standard and lighter loads

Eppendorf recommends using this platform installation procedure if you plan to operate the I26/26R shaker with any load that uses flasks 1 L in volume or below.

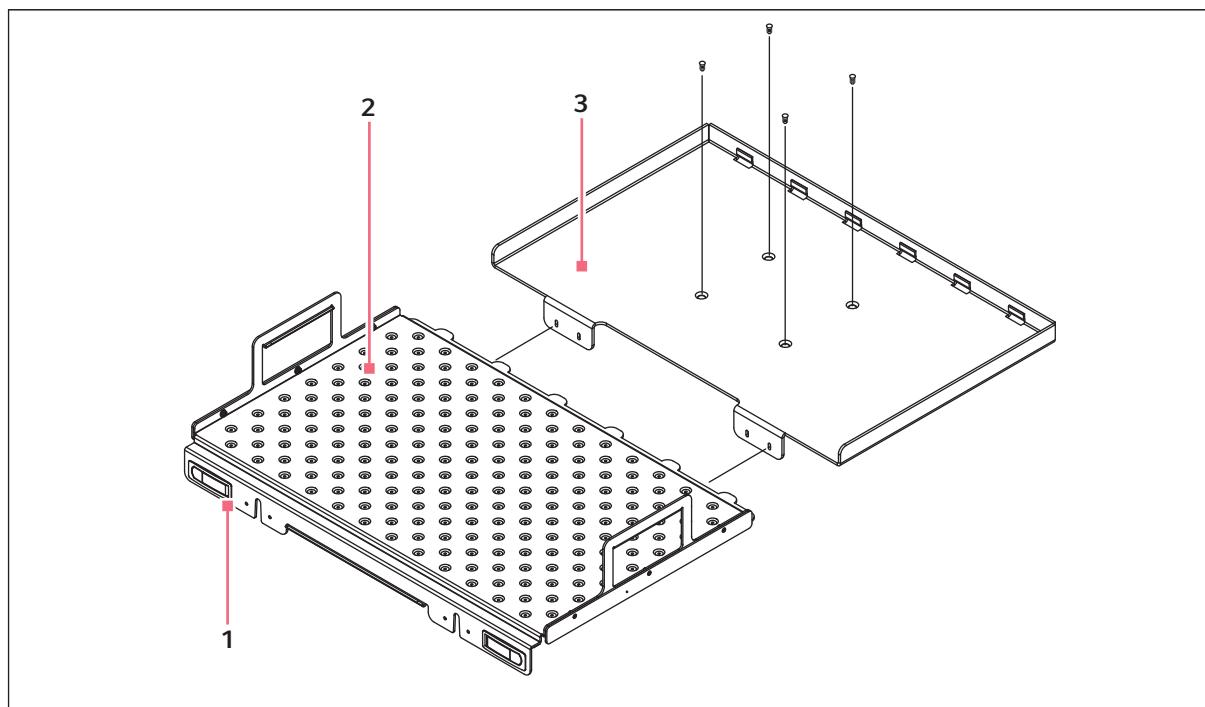

Fig. 1-1: Platform installation - standard and lighter loads

1 Latch

3 Subplatform

2 Platform

All platforms, once installed, will easily slide in and out of the shaker.

1. Press the buttons on the front of the platform to pop both latches out.
2. Using the handle on the center front of the platform, pull it forward to rest on the door guide strips. The two stop pins in the door will keep the platform from falling off the subplatform.
3. Slide it back in and be sure to securely close the latches before operating the shaker again.

Platform Installation Instructions

New Brunswick™ I26/26R Shaker Platform Installation
English (EN)

1.3 For heavier loads

If you are using heavier loads, it is recommended that you use knobs to secure the platform in place. The universal, 2 L, and 2.8 L dedicated platforms include a package containing the following parts:

- 2x P0220-9341 – KNOB, THREAD HOLE, 5/16-18, NYLON, BLK
- 2x S1224-2206 – SCREW CAP ALN 5/16-18X1-1/4 BLK
- Flat Washers and Lock Washers

To attach the knobs onto the existing platform:

1. Remove the subplatform and flip the subplatform upside down.
2. Insert screw as shown (see Fig. 1-2 on p. 4).

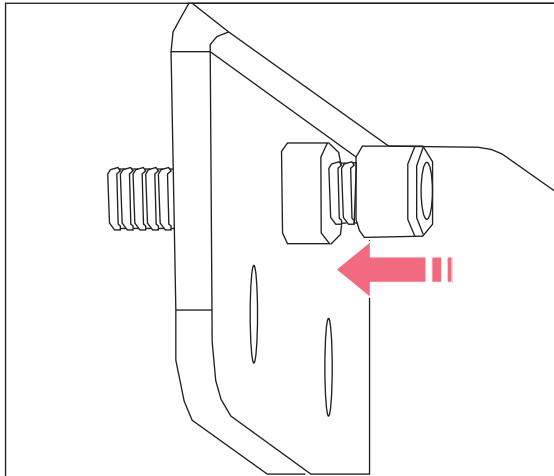

Fig. 1-2: Screw

3. Reinstall the subplatform.

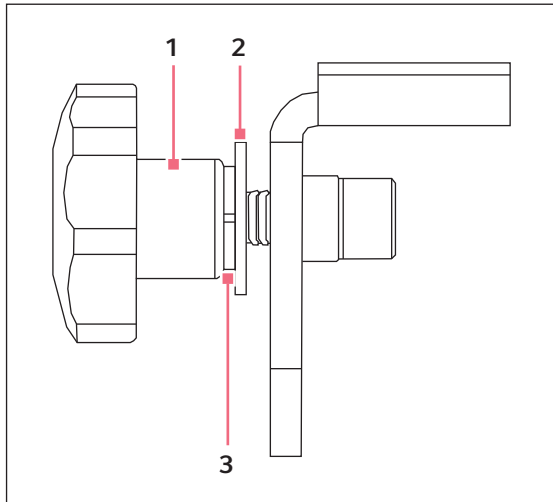

Fig. 1-3: Knob

1 Knob

3 Lock washer

2 Flat washer

4. Using the side handles of the platform (see Fig. 1-4 on p. 6), place the platform on the guide strips on the flat of the open door.
5. Push the platform toward the rear of the unit, aligning the bottom of the platform with the top of the subplatform, and making sure the sides are squared up with the subplatform sides.
6. When the platform is fully inserted and mated to the subplatform, install the flat washer and the lock washer as shown, and then screw the removable knob onto the screw; tighten appropriately (see Fig. 1-3 on p. 5).
7. Verify that the platform is now secured to the subplatform and the drive.

Platform Installation Instructions

New Brunswick™ I26/26R Shaker Platform Installation
English (EN)

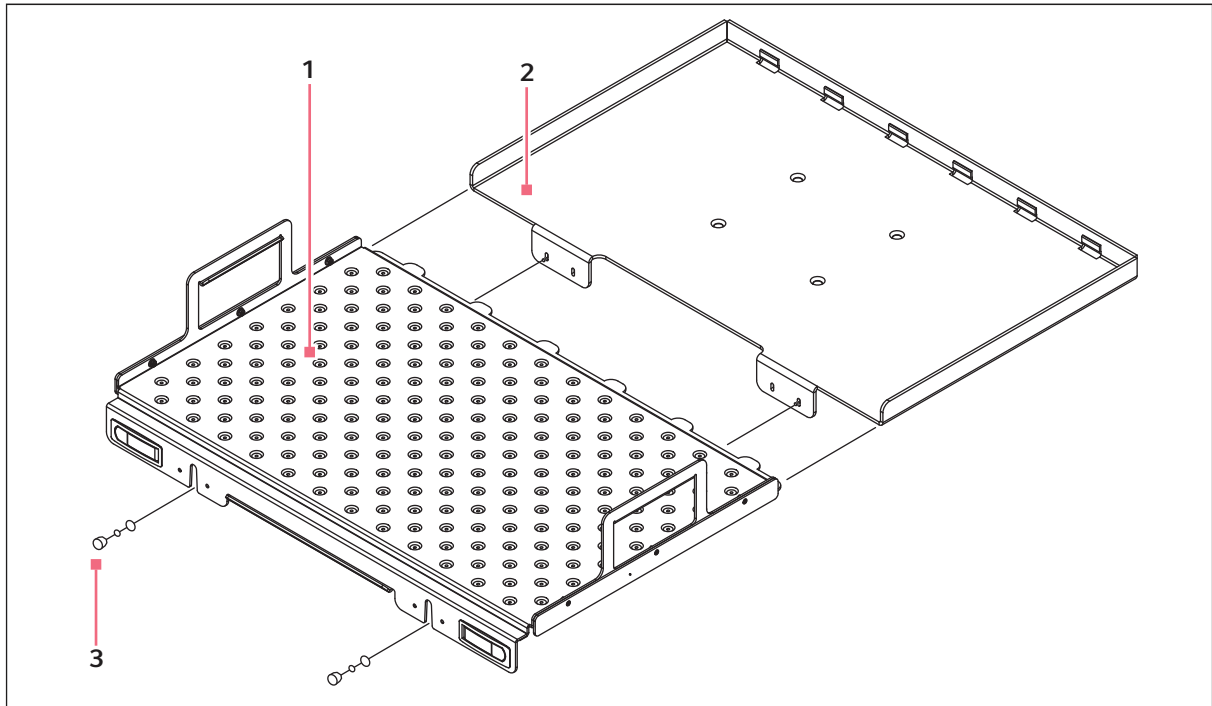

Fig. 1-4: Installing platform

1 Platform

3 Knob

2 Subplatform

1.4 Disposal

In case the product is to be disposed of, the relevant legal regulations are to be observed.

Information on the disposal of electrical and electronic devices in the European Community:

Within the European Community, the disposal of electrical devices is regulated by national regulations based on EU Directive 2012/19/EU pertaining to waste electrical and electronic equipment (WEEE).

According to these regulations, any devices supplied after August 13, 2005, in the business-to-business sphere, to which this product is assigned, may no longer be disposed of in municipal or domestic waste. To document this, they have been marked with the following identification:



Because disposal regulations may differ from one country to another within the EU, please contact your supplier if necessary.

In Germany, this is mandatory from March 23, 2006. From this date, the manufacturer has to offer a suitable method of return for all devices supplied after August 13, 2005. For all devices supplied before August 13, 2005, the last user is responsible for the correct disposal.

Evaluate your manual

Give us your feedback.

www.eppendorf.com/manualfeedback

Your local distributor: www.eppendorf.com/contact

Eppendorf AG · 22331 Hamburg · Germany

eppendorf@eppendorf.com · www.eppendorf.com